



RESIDENTIAL ESTATE AGENTS  
PROPERTY LETTING & MANAGING AGENTS  
VALUERS & PROPERTY CONSULTANTS  
CHARTERED SURVEYORS

**01722 336422**  
[www.hwwhite.co.uk](http://www.hwwhite.co.uk) WEB



**St. Albans Close, Bishopdown**

**£575,000 Freehold**

**1 St. Albans Close, Bishopdown, Salisbury, Wiltshire, SP1 3FN**



Energy Efficiency Rating		
	Current	Potential
Very energy efficient - lower running costs		
(92 plus) A		85
(81-91) B		
(69-80) C		
(55-68) D		
(39-54) E		
(21-38) F	74	
(1-20) G		
Not energy efficient - higher running costs		
England & Wales		EU Directive 2002/91/EC

A modern, detached family home in a small cul-de-sac in a popular development to the north of the city.

## Directions

From our offices in Salisbury, proceed along the London Road and after passing the petrol station on the left hand side, at the next roundabout take the left hand turning. St. Albans is the third turning on the right hand side.

## Description

A detached family home situated on a corner plot within a small cul-de-sac close to local facilities including a Mini Mart, veterinary surgery, doctor's surgery, and lovely countryside for dog walking. There is also an excellent local school (Greentrees) and public house. Close by is the large village green which is encircled by mature trees. There is gas central heating by radiators and the windows are double glazed. There is an enclosed and private rear garden with south and westerly aspects. There is an attached double garage and driveway parking. The accommodation consists of entrance hall, cloakroom, study, large sitting room, dining room, two conservatories, kitchen and utility room, four bedrooms, en-suite shower room and family bathroom.

There are a considerable number of wardrobes/storage cupboards. The property has been well maintained but could now do with updating. No chain.

## Services

All main services are connected.

## Outgoings

The Council Tax Band is 'F' and the payment for the year 2022/2023 payable to Wiltshire Council is £3,165.96.

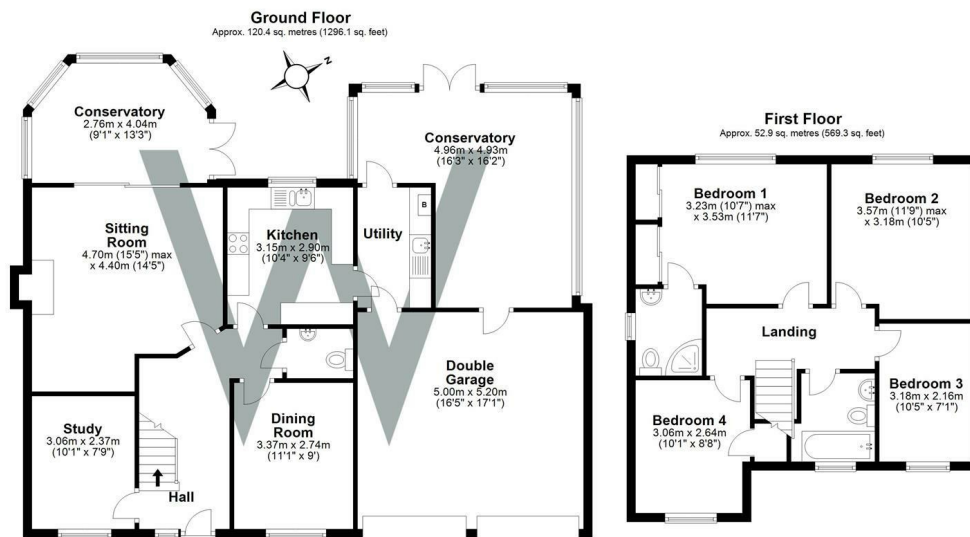

Total area: approx. 173.3 sq. metres (1865.4 sq. feet)

**W**  
**WHITES**

01722 336422

47 Castle Street, Salisbury SP1 3SP 01722 320600 FAX  
residential-sales@hwwhite.co.uk E-MAIL www.hwwhite.co.uk WEB